

DISTRIBUTED BY:

**TRUFast**  
WALLS

## VICTORY BEAR TRACK SYSTEM

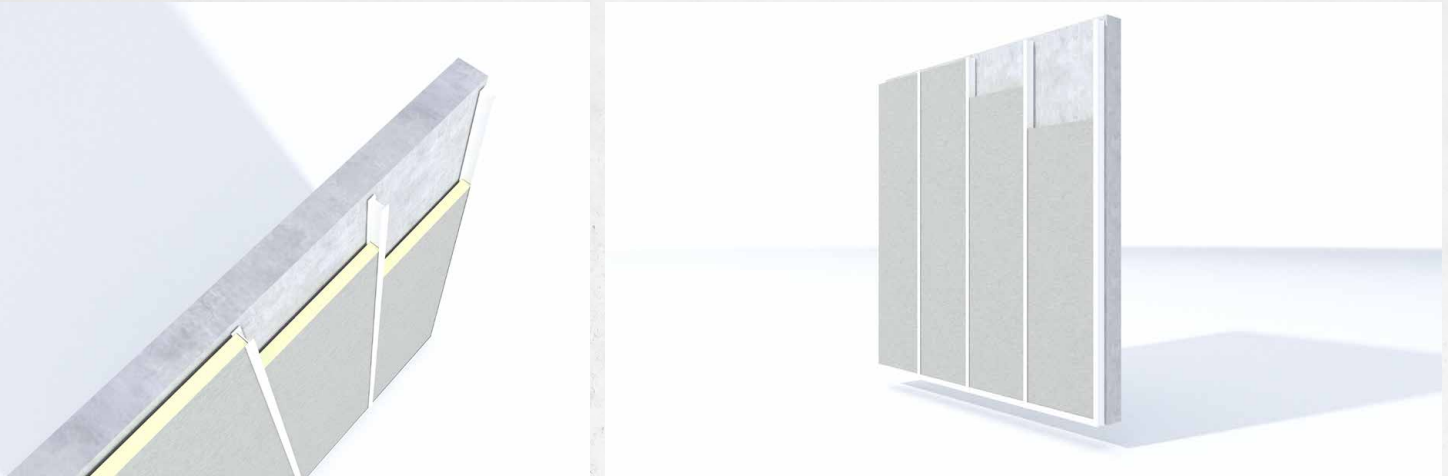

### INSULATION ATTACHMENT. FAST. CLEAN. FINISHED APPEARANCE.

#### ENERGY EFFICIENT DESIGN

-Flex-Tite Technology seals tightly against the insulation board to reduce thermal loss at seams.

#### REDUCES COST

-System is designed to withstand the impact of nail guns and saws, saving labor cost.

#### CONVENIENT FASTENING

-All Flex-Tite and Quick Clip systems have fastening leg for easy access with nail gun.

### CAN BE PAINTED

- If custom color is required, Victory Bear joint cover can be primed and painted

### INSTALLATION

- Step 1- Align the Flex-Tite J-Channel horizontally at the desired height and check for level. Fasten into place.
- Step 2- Align the Flex-Tite female clip vertically at desired spacing and check for plumb. Nail 3/4 to 1" into place.
- Step 3- Install insulation and Flex-Tite male, then repeat.

### MALE AND FEMALE

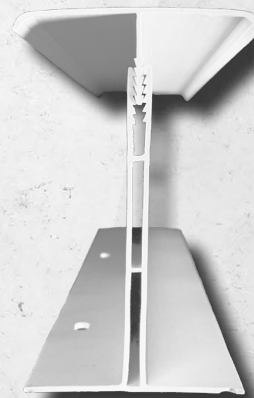

### J-CHANNEL



ALTENLOH, BRINCK & CO. U.S., INC.

ALTENLOH, BRINCK & CO. - GROUP

**TRUFast**  
WALLS

130 Graham St. SW, Grand Rapids, MI 49503 • 616-454-3100 • wallssales@trufast.com • www.trufastwalls.com

Bulletin No. TFW-2012