

Not to scale.



## MATERIAL SPECIFICATIONS

Polypropylene

## PRODUCT DESCRIPTION

TRUFAST®'s Plasti-Grip® PMF Anchor is a molded plastic insulation fastener for masonry substrates. Permanently attach rigid and semi-rigid insulation to masonry, concrete, block, brick, or stone substrates. The 2-3/8" diameter head secures the insulation, while the plastic shank prevents thermal-bridging. Attaches insulation 1" - 5" thick, with no adhesives, screws, or pins required.

## PRODUCT FEATURES

- Attaches all types of rigid insulation to concrete or masonry substrates.
- 2-3/8" diameter washer head.
- Simple to install - drill and hammer.
- No pins, screws, or adhesives required.
- Solid plastic design reduces thermal-bridging by eliminating inefficient screws / pins.
- Textured head design for basecoat adhesion when used with EIFS system.

## PRODUCT SELECTION

Part No.	Part Length	Pkg. Qty.	Pkg. Wt.
PMF-2000	2"	250	4 lbs.
PMF-2750	2-3/4"	250	5 lbs.
PMF-3500	3-1/2"	250	6 lbs.
PMF-4500	4-1/2"	250	6 lbs.
PMF-5375	5-3/8"	200	8 lbs.
PMF-6250	6-1/4"	200	5.6 lbs.

## PRODUCT SPECIFICATIONS

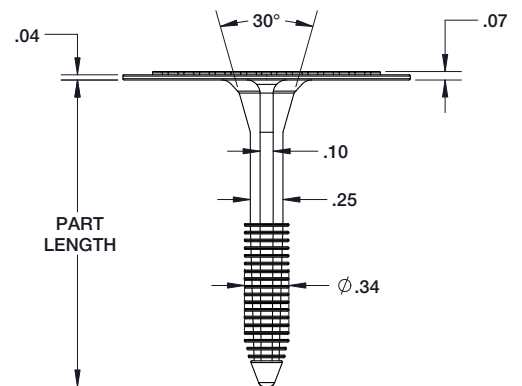
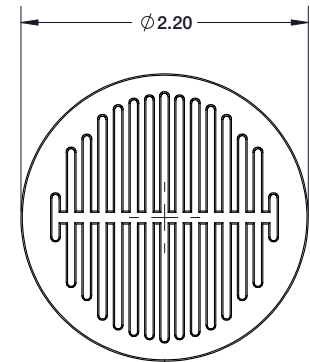

### INSTALLATION GUIDELINES

Pre-drill hole with 5/16" masonry bit, then tap PMF with hammer until flush. The 2-3/8" diameter head permanently attaches insulation with a flush finish. The solid plastic design reduces thermal-bridging by eliminating inefficient screws / pins. Be sure to drill deeper than anticipated shank penetration and clean out hole to prevent bottoming

out and a flush washer head finish. Also, for best results be sure to use a sharp 5/16" masonry bit with high quality hammer drill. Dull bits will dwell in the hole while drilling creating a chance the hole will enlarge and reduce pull-out resistance.



PMF ANCHOR LENGTH	INSULATION THICKNESS
2"	1/2" - 3/4"
2-3/4"	1" - 1-1/2"
3-1/2"	1-1/2" - 2"
4-1/2"	2-1/2" - 3"
5-3/8"	3-1/2" - 4"
6-1/4"	4-1/4" - 5"

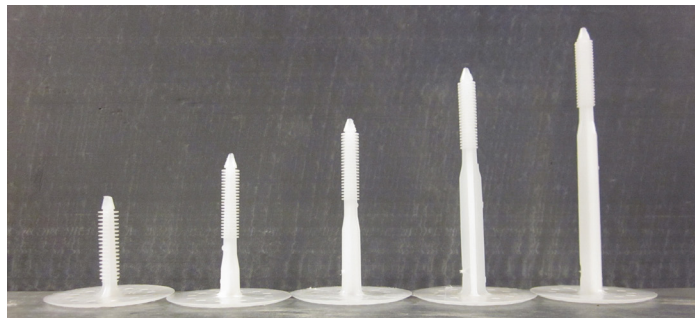

Bulletin No. TFW-24024

### DISCLAIMER

The information provided here is subject to change without notice. The performance specifications published in this TRUFAST® product literature are based on controlled laboratory tests and are intended as a guideline only. They are not guaranteed in any way by the ALTENLOH, BRINCK & CO. US, INC., since building design, engineering,

and construction, including workmanship and materials, are beyond the control of the manufacturer. The manufacturer recommends that pull-out tests be conducted to verify the substrate provides adequate pull-out values.