

Not to scale.

PRODUCT DESCRIPTION

The Thermal-Grip[®] TubeSeal[™] fastener from TRUFAST[®] Walls is designed to help seal blind fastener penetrations of your WRB and air-barrier when mechanically attaching continuous insulation. Mineral wool and rigid foam insulation must be mechanically attached, and often over a WRB or air-barrier. With the Thermal-Grip TubeSeal you enable sealing on the facer of the WRB or air-barrier sandwiched between the substrate and the layer of continuous insulation.

Available pre-assembled with various screws including self-drilling (SDS in the chart below) for steel and HiLo for wood.

CODE & TESTING

ASTM E331*

ASTM E1186

ASTM E2357

*Multiple assemblies of various insulations attached over various air/water barriers have been tested as per E331 up to 25 psf with no leakage. Please inquire for additional details.

MATERIAL SPECIFICATIONS

Fastener components made of various proprietary materials including:

Washer - Polypropylene

TubeSeal - Polyurethane

Screw - Carbon steel with proprietary exterior grade coating

PRODUCT SELECTION

Part No.	Part Length	Pkg. Qty.	Pkg. Wt.
GDTS-HL-1000	HiLo for 1" insulation	500 pcs.	12 lbs.
GDTS-HL-1500	HiLo for 1" insulation	500 pcs.	13 lbs.
GDTS-HL-2000	HiLo for 1" insulation	500 pcs.	15 lbs.
GDTS-HL-2500	HiLo for 1" insulation	250 pcs.	12 lbs.
GDTS-HL-3000	HiLo for 1" insulation	250 pcs.	12 lbs.
GDTS-HL-3500	HiLo for 1" insulation	250 pcs.	12 lbs.
GDTS-HL-4000	HiLo for 1" insulation	250 pcs.	12 lbs.
GDTS-SD-1000	SDS for 1" insulation	500 pcs.	12 lbs.
GDTS-SD-1500	SDS for 1" insulation	500 pcs.	13 lbs.
GDTS-SD-2000	SDS for 1" insulation	500 pcs.	15 lbs.
GDTS-SD-2500	SDS for 1" insulation	250 pcs.	12 lbs.
GDTS-SD-3000	SDS for 1" insulation	250 pcs.	12 lbs.
GDTS-SD-3500	SDS for 1" insulation	250 pcs.	12 lbs.
GDTS-SD-4000	SDS for 1" insulation	250 pcs.	12 lbs.



PRODUCT FEATURES

- Grip-Deck[®] TubeSeal[™] insulation fasteners are designed to seal blind fastener penetrations of a WRB or air-barrier.
- Tube available in multiple lengths for insulation nominal thickness of 1", 1.5", 2", 2.5", 3", 3.5", and 4".
- UV resistant ether-based polyurethane tube is suitable for all weather climates.
- Patented and/or patent pending.

Test matrix included multiple configuration of insulation attached over multiple WRB types including:

	Sheet	Fluid	Self-Adhered	Integrated
ISO	X	X	X	X
XPS	X	X	X	X
Mineral Wool	X	X	X	X

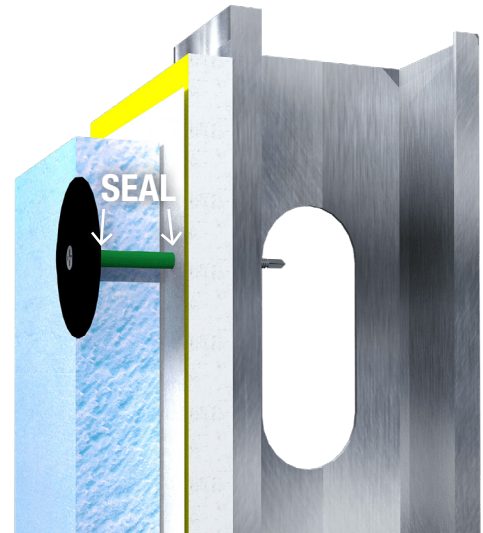

INSTALLATION GUIDELINES

Ensure that tube length is appropriate for the thickness of insulation being installed (approximately 10% longer than insulation thickness) to ensure adequate compression and seal on underside of washer and surface of WRB.

Washer is designed to flatten on face of the insulation for flush installation of cladding.

Generally tested and accepted industry fastening patterns for 4'x8' XPS and ISO insulation panels is 16"x16" for full attachment.

Generally tested and accepted industry fastening patterns for 2'x4' mineral wool panels is 5 fasteners per panel.

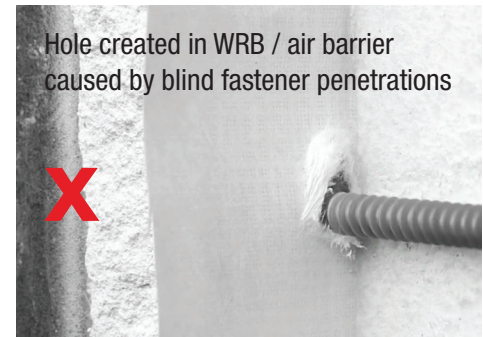

Hole created in WRB / air barrier caused by blind fastener penetrations



Grip-Deck TubeSeal[™] compresses against WRB / air barrier to help seal out air and water

Bulletin No. TFW-23111

DISCLAIMER

The information provided here is subject to change without notice. The performance specifications published in this TRUFAST[®] Walls product literature are based on controlled laboratory tests and are intended as a guideline only. They are not guaranteed in any way by the ALTENLOH, BRINCK & CO. US, INC., since building

design, engineering, and construction, including workmanship and materials, are beyond the control of the manufacturer. The manufacturer recommends that pull-out tests be conducted to verify the substrate provides adequate pull-out values.